

## ARCHITECTURAL SPECIFICATIONS

**COMMERCIAL LIMITED DUTY  
GEARHEAD JACKSHAFT**

The PRO-GJ is designed for use on commercial sectional doors with high or vertical lift track and small rolling doors, shutters and grilles that require no more than 15 cycles per hour.

**■ STANDARD FEATURES**

- 1/2HP High starting torque motor with overload protection
- Heavy duty worm gear in oil-bath reducer
- 24V Fused Control Circuit
- C-2 wiring standard. Safety equipment must be installed when B-2 wiring is used.
- External radio control terminal strip
- Three Button Control Station
- Fully adjustable rotary limit switches
- Powder metal limit cams
- #41 roller chain drive & 41B32 door sprocket supplied as standard
- Chain Keeper
- Floor level disconnect for emergency manual operation
- Suitable for emergency egress device
- Motor removable without affecting limit settings
- Left or right hand mounting (must specify at time of order)
- Baked on dark grey coat finish
- Approximate shipping weight 55 Lbs.
- Control logic circuit board c/w load sensing feature (Optional)

## OVERALL DIMENSIONS

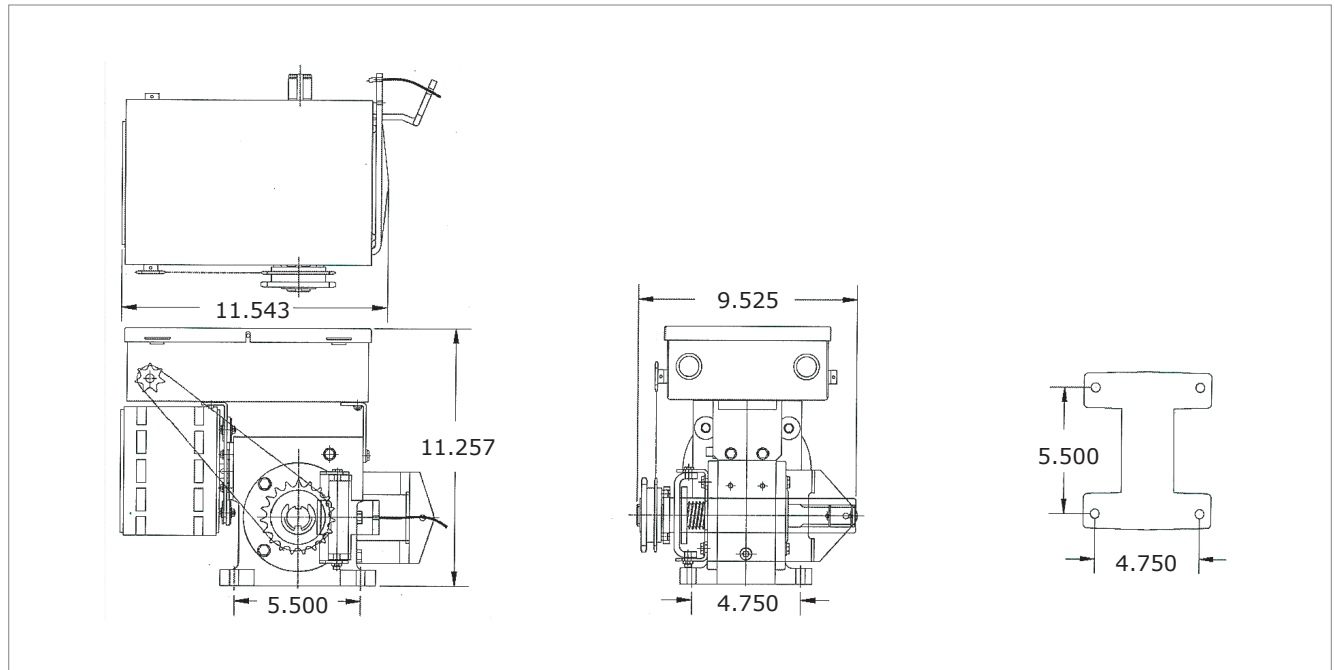

## HORSEPOWER SELECTION & MOTOR AMPERAGE GUIDE

PRO-GJ HORSEPOWER SELECTION GUIDE BELT DRIVE JACKSHAFT / MEDIUM DUTY (15 CYCLES/HR)					
ROLLING DOORS					
Steel	24GA	22GA	20GA	18GA	16GA
Insulated Steel					
Other	Aluminum Grilles	Aluminum Doors			
HORSEPOWER	MAXIMUM SQUARE FEET				
1/2HP - 373W	310	265	215	190	150
MOTOR AMPERAGE GUIDE (Amps) LIMITED DUTY					
VOLTAGE	1/3	1/2	3/4	1	
110V 1-phase		5.5			